

RULES
&
REGULATIONS

1. All people are welcome to enjoy themselves without charge in these conservation areas of the Town from 1/2 hour before sunrise to 1/2 hour after sunset.
2. No cars, trucks or other powered vehicles or tools are allowed without the consent of the Conservation Commission or their agent.
3. "No Hunting" or "No Fishing" signs will be posted if such is intended. If not posted, areas may be hunted or fished in season with license and in accord with applicable law.
4. In these areas, no person shall cut, break, remove, deface, defile or ill use any structure, fence, sign, or have possession of any part thereof. No growing trees, bushes, plants or flowers shall be defaced or cut nor shall trails be cut or marked, nor dams built nor any structure such as lean to, bridge, tower, or handrail be constructed without authorization of the Conservation Commission. No vegetation, either live or dead, shall be removed from these areas.
5. Soliciting, advertising and business activities are strictly prohibited within these areas.
6. Overnight camping in these areas may be permitted to organizations having an adult leader present at all times. Every group shall obtain prior written permission from the Conservation Commission, must obtain a fire permit if open fires are planned and must each time notify the Police Department and the Natural Resources Department of both exact dates of occupancy and identity of the accompanying responsible adult.
7. The Conservation Commission cannot assume for the Town, liability for injuries, damage to property or other loss to persons going on such areas, who assume all the risks involved.
8. Littering and/or dumping (leaves, brush, trash, etc.) within these areas is strictly prohibited.
9. Violations of these regulations may result in fines of up to \$300 for each offense. Each day a violation continues shall constitute a separate offense.

PLEASE-DO NOT LITTER
Beware of Poison Ivy & Poison Sumac
ABOVE ALL, LET NATURE MAKE ALL THE CHANGES.

Horse Pond Conservation Area

The Horse Pond trails are located within a 400 acre tract of Town owned land to the east of Higgins Crowell Road in West Yarmouth. The main trail occurs along the northern perimeters of Horse Pond with spurs, loops and connectors to other trail systems.

The western entrance and parking is on Higgins Crowell Road. The trail starts traversing Water Dept property and enters onto Conservation property approximately ¼ mile to the east. Once on the Conservation property the trail exhibits topographic changes with some "dry kettle" formations on either side of the trail. These glacial remnants are from large ice pieces that remained as the glacier retreated. As the outwash streams deposited soils and clays, the land built up around the kettle. Once the ice completely melted, the remaining feature was as it is today, existing as a remarkable depression.

Horse Pond contains an area of approximately 30 acres. It is quite shallow with a maximum depth of around 10 feet. The pond exhibits large fluctuations in shoreline due to neighboring public wells. This fluctuation in water level provides a unique habitat for many rare and endangered plants to survive. In the summer, large areas of Plymouth Gentian are visible along the shoreline.

The upland portions of the property exhibit typical Pitch Pine and Oak vegetative associations with understories of low bush blueberry and huckleberry. The wetland portions display Red Maple, Gray Birch and Tupelo canopies with Pepperbush shrub layers.

Two wet meadows occur to the north of Horse Pond. During high precipitation years, they support standing water. During low precipitation years they support a diverse plant community consisting of grasses, sedges, sundews and rushes. The wet meadows also support rare and endangered vegetation.

Connector trails link Horse Pond with Sandy Pond, Bassett's Lot Pond, Plashes Pond cranberry bogs and eventually the R.J Syrjala Conservation Area.

HORSE POND CONSERVATION AREA



Town of Yarmouth Conservation Commission



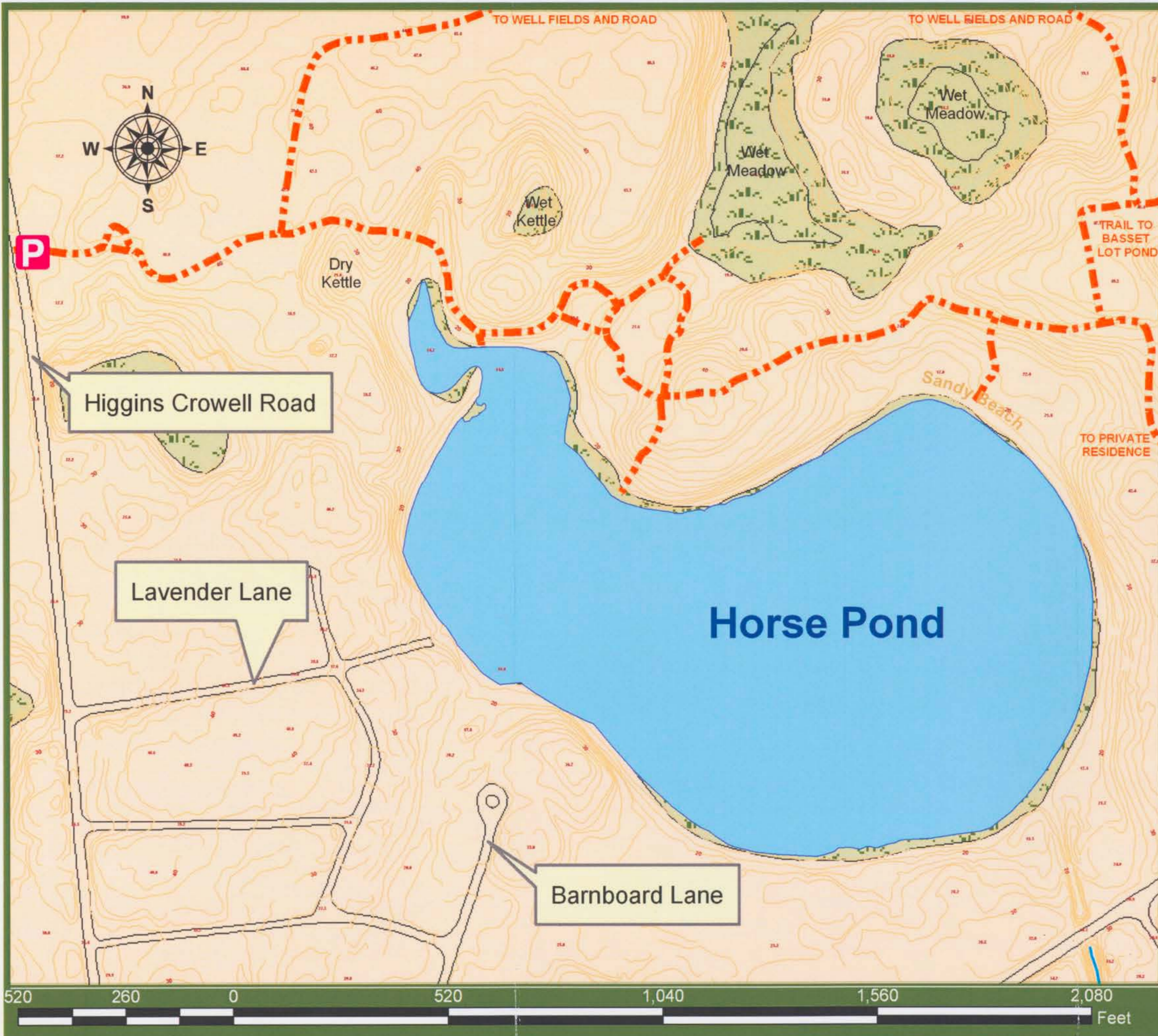

Horse Pond

Yarmouth Conservation Commission

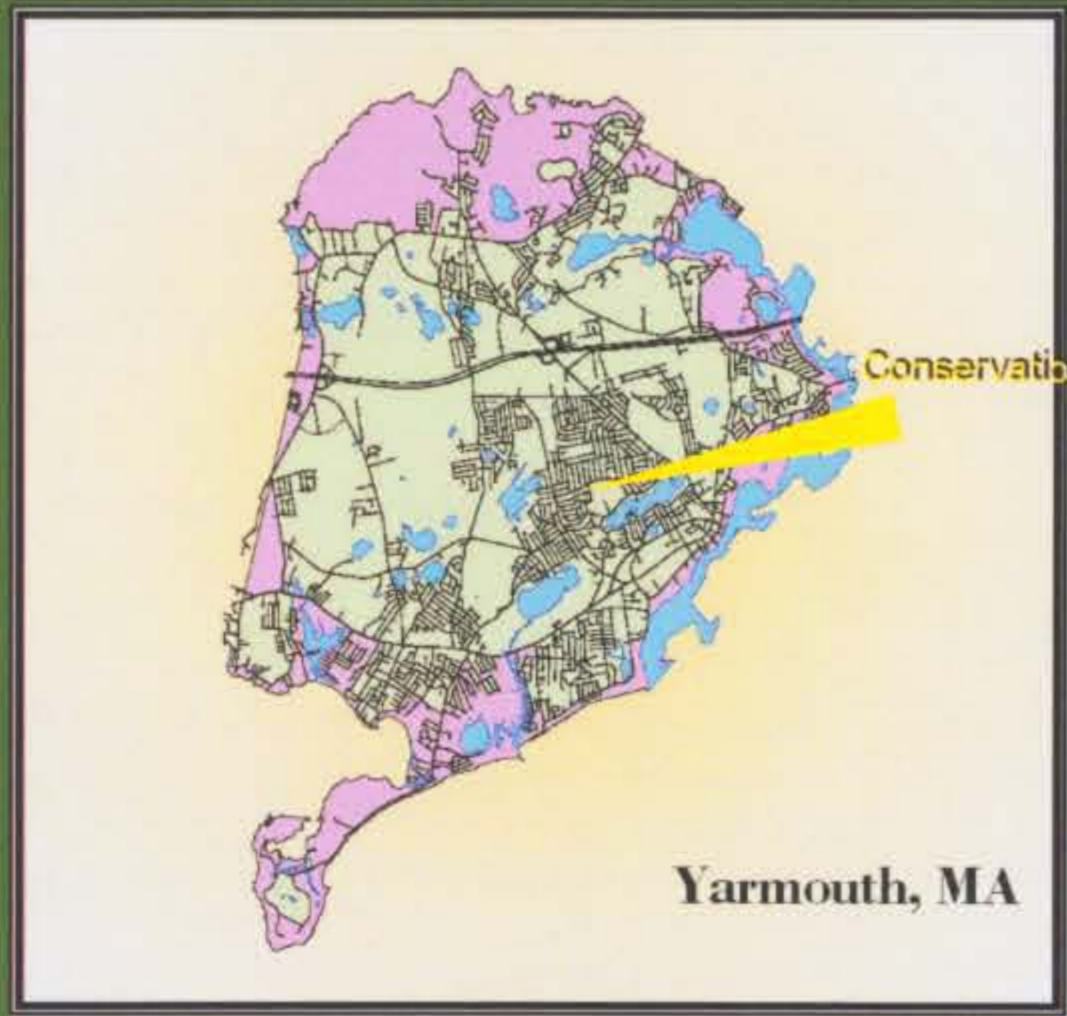

Location: on Higgins Crowell Road in West Yarmouth, near the Mattacheese School.

TOTAL TRAIL DISTANCE: 0.92 miles

- Legend**
- Walking Trails
 - Wetlands
 - Lakes
 - Town Bounds
 - Hydro
 - Parking Area
 - Contour



Special thanks to Bradford Hall, Bruce Barrow, Tim Smith and Mark Adams for their time and efforts. Produced by Chris Sethness, ACC year VI.